

Section 1-1 - As Proposed

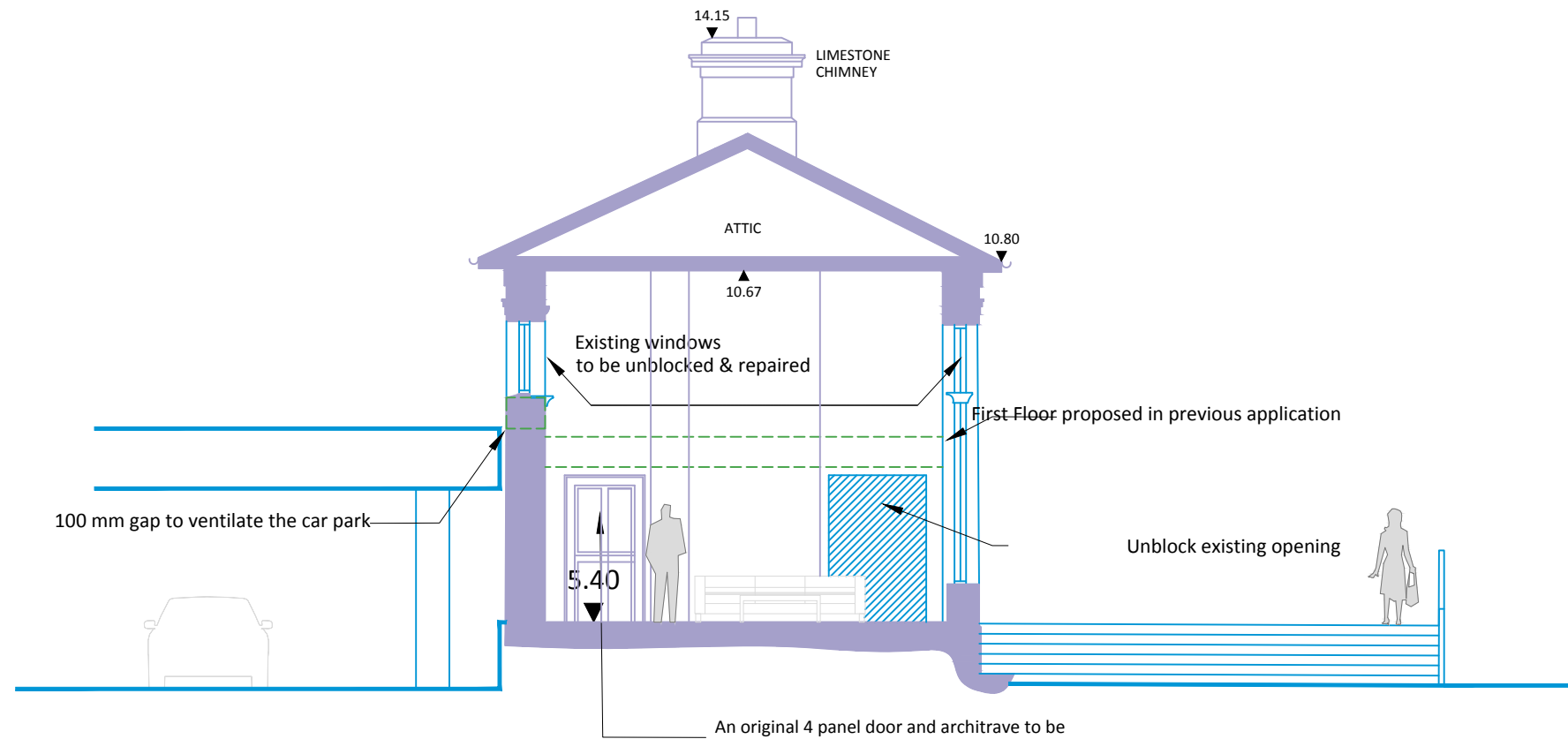

Section 2-2 - As Proposed

Stationmaster's Building - Sections 1-1 & 2-2 -As Proposed

- Building fabric to be retained
- Building fabric to be removed
- Proposed interventions
- Outline of residential block permitted under 17/37563

Any surviving windows to be retained and repaired. This includes the semi lunar windows at the rear elevation. New windows to replace missing and damaged windows to be modeled on the surviving windows.

Refer to Conservation Report prepared by JCA Architects for further details on Protected Structures

Revision	Description	Date	Rev. No.	Issued by
SDH application		09-08-2019	3	AW
SHD Pre application		22-03-2019	2	SV
Planning		15-02-2019	1	IT



Figured dimensions only to be used. This drawing is copyright of O'Mahony Pike Architects Ltd. All information is shared as per approved use in accordance with BS1192(2007) + A2(2016), Table 5; Standard Codes for Suitability of Models and Documents. If 'Information Approval Check' is empty, this information has been shared at S0 - WIP.



architecture | urban design
 email: info@omahonypike.com
 tel: +353 1 202 7400
 fax: +353 1 283 0822
 www.omahonypike.com

Dublin
 The Chapel
 Mount St. Anne's
 Milltown, Dublin 6

Cork
 26 South Mall
 Cork City
 Co. Cork
 D06 XN52 Ireland
 T12 R2RV Ireland

Project: HQ Horgan's Quay
Location: Horgan's Quay, Cork
Client: HQ Developments Ltd.

Drawing Title: Stationmaster's Building - Sections 1-1&2-2 -As Proposed
Drawing No.: HQDRQ-OMP-PS1-ZZ-DR-A-3901

Project No.: 1623
Project Lead: CK
Drawn By: IT
Model No.: HQDRQ-OMP-PS1-XX-DR-A-0900
Purpose: S4

Scale @ A3: 1:100
Date Printed: 09-08-2019
Current Rev.: 3

Suitability - Checked By - Date