

Section 1-1 - Existing

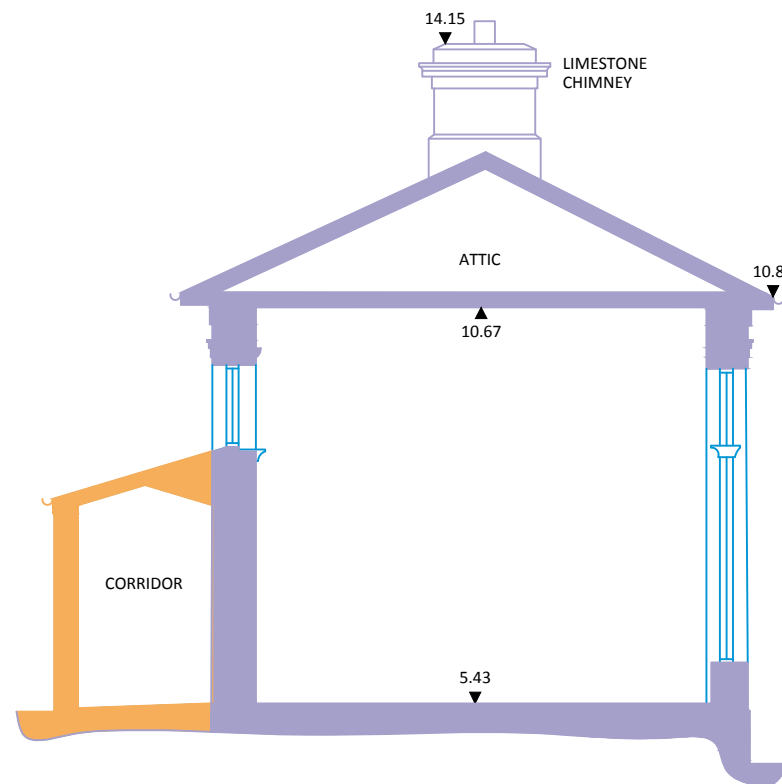

Section 2-2 - Existing

Stationmaster's Building - Sections 1-1 & 2-2 - Existing

- Building fabric to be retained
- Building fabric to be removed
- Proposed interventions

Any surviving windows to be retained and repaired. This includes the semi lunar windows at the rear elevation.  
 New windows to replace missing and damaged windows to be modeled on the surviving windows.

Refer to Conservation Report prepared by JCA Architects for further details on Protected Structures

Revision Description	Date	Rev. No.	Issued by
SDH application	09-08-2019	3	AW
SHD Pre application	22-03-2019	2	SV
Planning	15-02-2019	1	IT



Figured dimensions only to be used. This drawing is copyright of O'Mahony Pike Architects Ltd. All information is shared as per approved use in accordance with BS1192(2007) + A2(2016), Table 5; Standard Codes for Suitability of Models and Documents. If 'Information Approval Check' is empty, this information has been shared at S0 - WIP.



architecture | urban design  
 email: info@omahonypike.com  
 tel: +353 1 202 7400  
 fax: +353 1 283 0822  
 www.omahonypike.com

**Dublin**  
 The Chapel  
 Mount St. Anne's  
 Milltown, Dublin 6  
 Co. Cork

**Cork**  
 26 South Mall  
 Cork City  
 Co. Cork  
 T12 R2RV Ireland

**Project:** HQ Horgan's Quay  
**Location:** Horgan's Quay, Cork  
**Client:** HQ Developments Ltd.

**Drawing Title:** Stationmaster's Building - Sections 1-1 & 2-2 - Existing  
**Drawing No.:** HQDRQ-OMP-PS1-ZZ-DR-A-3900

**Project No.:** 1623  
**Project Lead:** CK  
**Drawn By:** IT  
**Model No.:** HQDRQ-OMP-PS1-XX-DR-A-0900  
**Purpose:** S4

**Scale @ A3:** 1:100  
**Date Printed:** 09-08-2019  
**Current Rev.:** 3

**Suitability - Checked By - Date**